

ALTA	MODEL NYF 150 SS 150# ANSI STAINLESS STEEL RAISED FACE FLANGED "Y" STRAINER	DRAWING A 122
-------------	------------------------------------------------------------------------------------------------------------------	----------------------

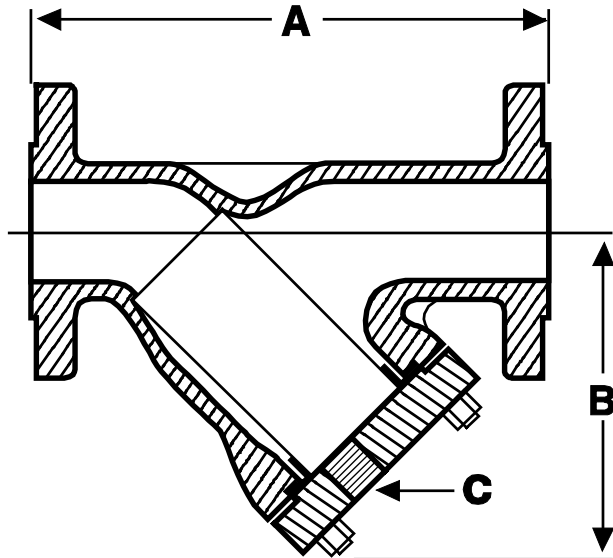

DESCRIPTION	MATERIAL
BODY	ASTM A351 GR CF8M
COVER	ASTM A351 GR CF8M
STUD	ASTM A193 GR. B8
NUT	ASTM A194 GR. B8
GASKET	TEFLON
SCREEN 1" TO 1 1/2"	304 SS 1/32 PERF
SCREEN 2" TO 10"	304 SS 1/8 PERF

TEMPERATURE		WORKING PRESSURE	
C	F	kPa	P.S.I.
-29 to 38	-20 to 100	1896	275
95	200	1655	240
150	300	1480	215
200	400	1345	195

FLANGES ARE IN ACCORDANCE WITH ANSI B16.5

ALL STRAINERS ARE INDIVIDUALLY HYDROSTATICALLY TESTED TO ANSI B16.5

SIZE		DIMENSIONS				SCREEN REMOVAL		NET WEIGHT	
		A		B					
mm	in.	mm	in.	mm	in.	mm	in.	Kg.	Lbs.
25	1	162	6 3/8	127	5	15	1/2	5	11
40	1 1/2	197	7 3/4	133	5 1/4	15	1/2	7.7	17
50	2	200	7 7/8	152	6	20	3/4	10.4	23
80	3	254	10	177	7 1/2	25	1	19	42
100	4	308	12 1/8	279	11	40	1 1/2	33	73
150	6	470	18 1/2	368	14 1/2	50	2	64	140
200	8	549	21 5/8	525	20 5/8	50	2	116	255
250	10	660	26	584	23	50	2	161	355
300	12	762	30	660	26	50	2	209	490

LARGER SIZES AVAILABLE . PLEASE CONTACT US FOR DIMENSIONS.

FEATURES BODY HAS A MACHINED SEAT TO HOLD SCREEN SECURELY.

COVER HAS A MACHINED SCREEN HOLDER TO ALIGN SCREEN DURING INSTALLATION AND TO RETAIN SEDIMENT WHEN COVER IS REMOVED.

BODY IS MACHINED TO HOLD COVER GASKET IN A BLOW-OUT PROOF DESIGN.

FLANGES ARE BACK FACED OR SPOT FACED.